

Oclean

Product User Manual

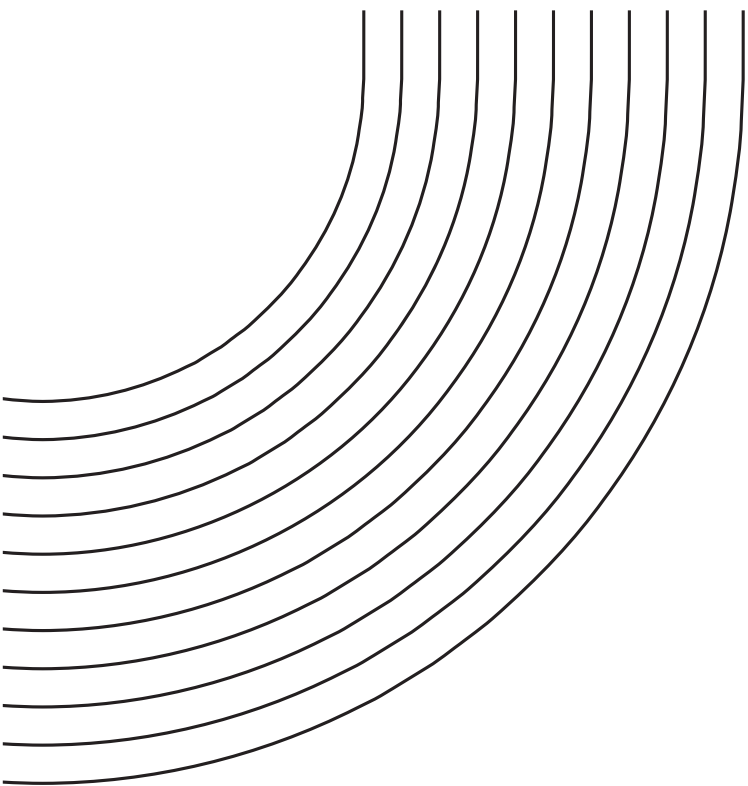

Toothbrush Body

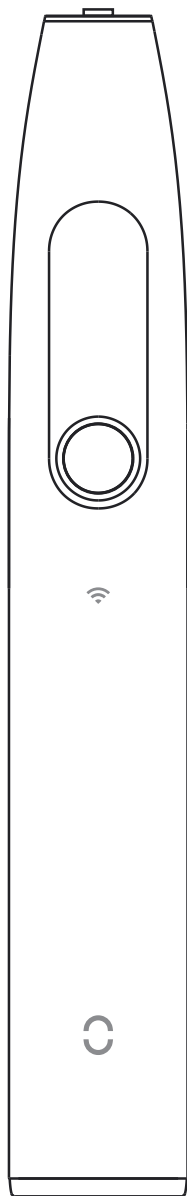

Travel Case

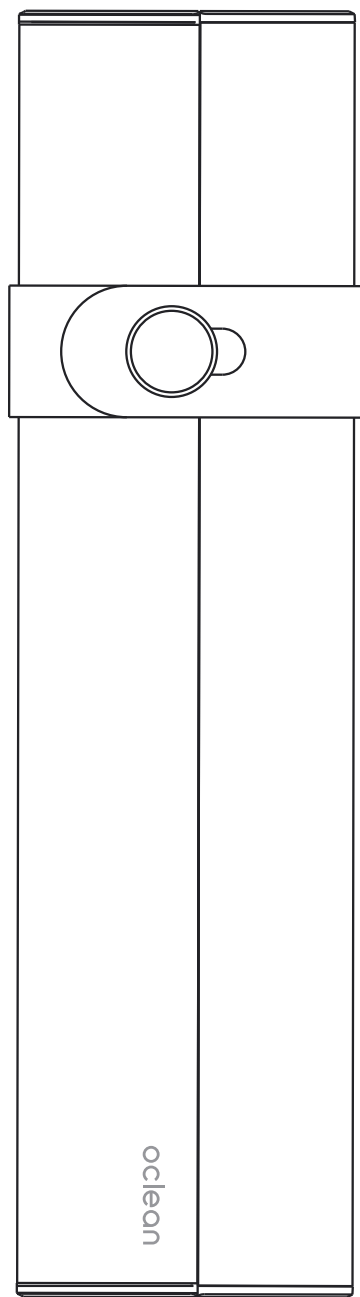

Wall-Mount

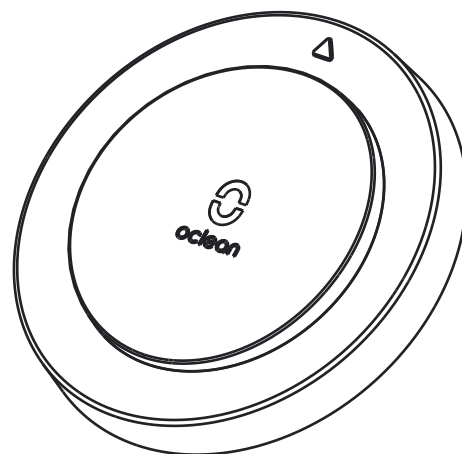

Brush Head

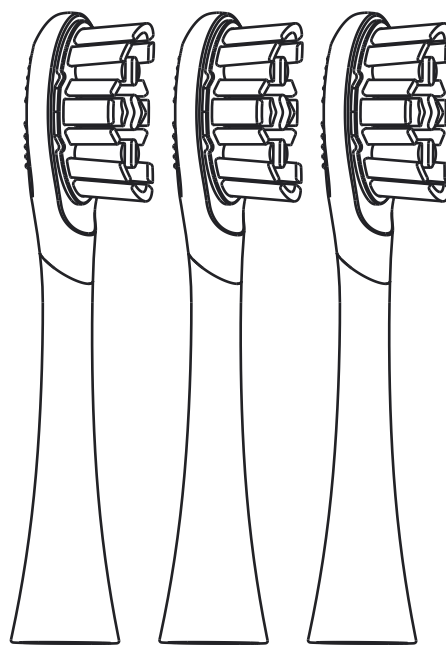

Charging Base

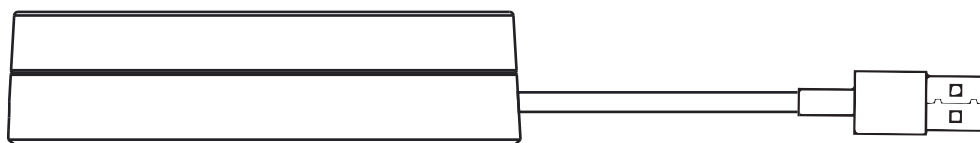

Oclean X Ultra S WiFi Smart Sonic Electric Toothbrush

Important Safety Precautions

1. This product is recommended for user over 12 years old. Only Oclean special brush heads can be used. Oclean will not be responsible for any consequences caused by non-certified brush heads of any third party.
2. This product is only for personal cleaning. It is not recommended for medical use or multi-user use. Do not place it in direct sunlight. It is recommended to place it in a dry and ventilated place at room temperature.
3. Please keep the device dry before charging, wipe it with a soft cloth, and clean the charging stand with dry cloth regularly to prevent stains from accumulating.
4. People who have just undergone oral periodontal surgery or are currently undergoing treatment, including those with loose dentures or persistent heavy bleeding from the gums, are not recommended to use this product, or should consult a professional dentist before use.
5. This product is not suitable for use by disabled persons, mentally ill persons or persons lacking relevant experience and knowledge [including children (0-12 years old)]. Unless it is used under the supervision and guidance of their guardian.



Brush Head

When replacing the brush head, please pull it out or insert it vertically, do not rotate it left or right. Dentists recommend replacing the brush head every 2-3 months.

Touch Screen

Support up and down sliding operation, please touch it with the tip of your finger.

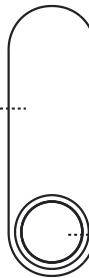

ON/OFF Key

After the toothbrush is awakened, the operation will be paused after the ON/OFF key is pressed during operating; the operation will continue if it is pressed again within 30 seconds; if it is not operated for more than 30 seconds, the screen will turn off and sleep. It can be restored to the factory mode by holding the ON/OFF key for 8 seconds.

Wireless Charging

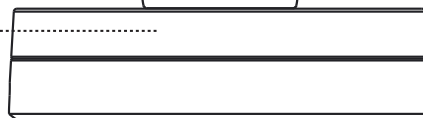

First Startup

1. Use it for the first time:

Press the ON/OFF button to turn on the toothbrush, after which it will remain in standby mode. When the screen is on, Bluetooth and WiFi will remain enabled. When the screen is off, Bluetooth and WiFi will be disabled after 30 seconds if it is not operated.

2. Install the APP:

After downloading the "Oclean Care+" APP, please search and connect the toothbrush in the APP (Note: the connection in the phone's "System Settings-Bluetooth Settings" is invalid). After installing the App, you can set various functions for the toothbrush, such as enabling and disabling the "Area Change Reminder". You can also customize a brushing plan that suits you and push the customized brushing plan directly to the toothbrush.

3. APP connection steps:

Home - Add Device - Select WiFi - Enter password - Connecting - Connect successfully

- 1 Scan the QR code or search for Oclean Care+ on your Apple Store to download.



Google Play Store & iOS APP Store

- 2 New users tap "Register account" to create an account.

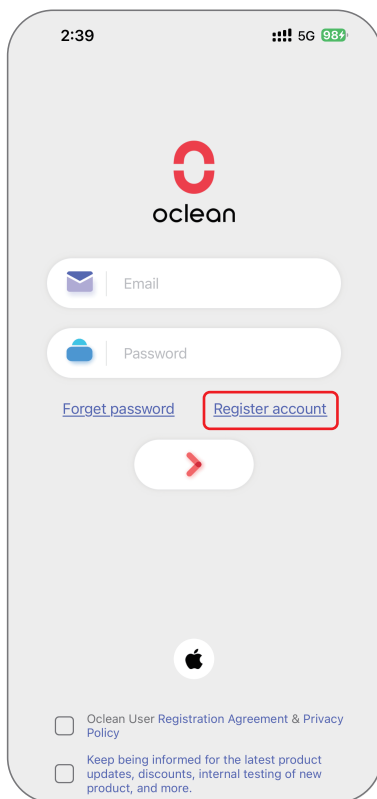

- 3 Enter your user-name and password, then tap ">".

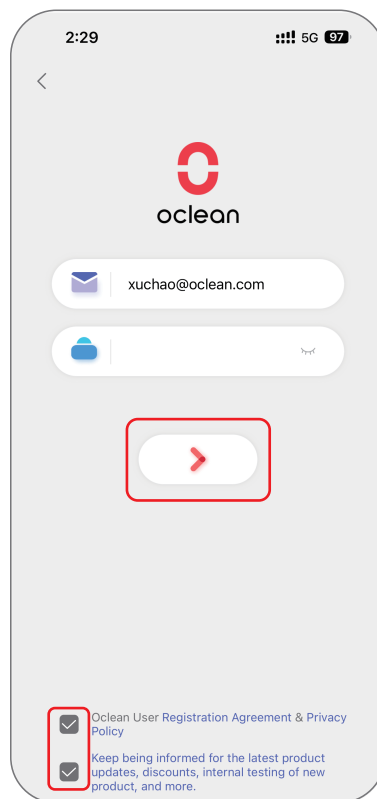

- 4 Enter the verification code, then tap "Completed".

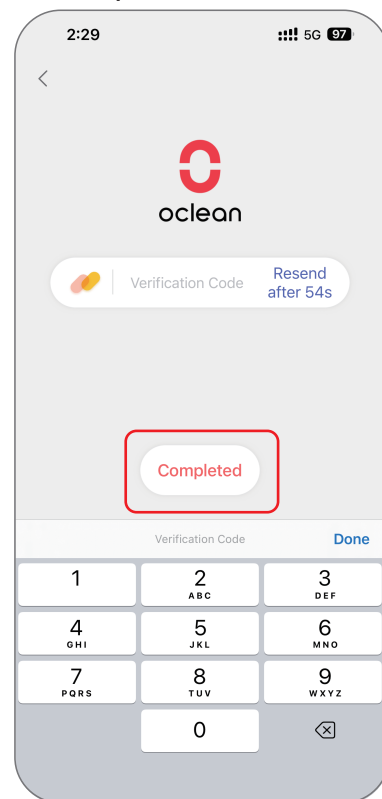

- 5 Bring the toothbrush close to your phone.



- 6 Open the app and tap "Add device" to go to the device connection page.

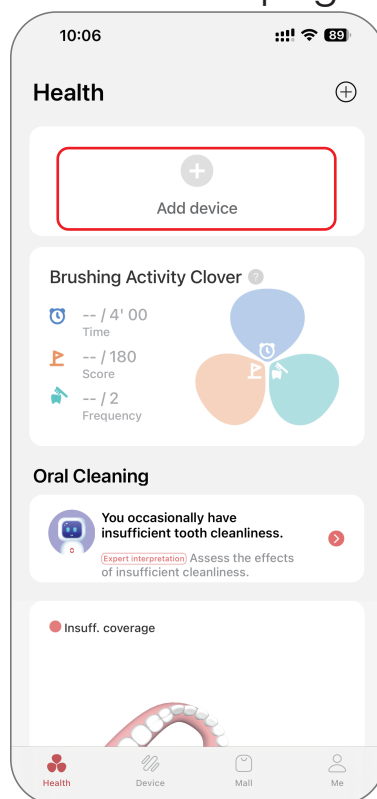

- 7 Tap "Next" to enter the search page.

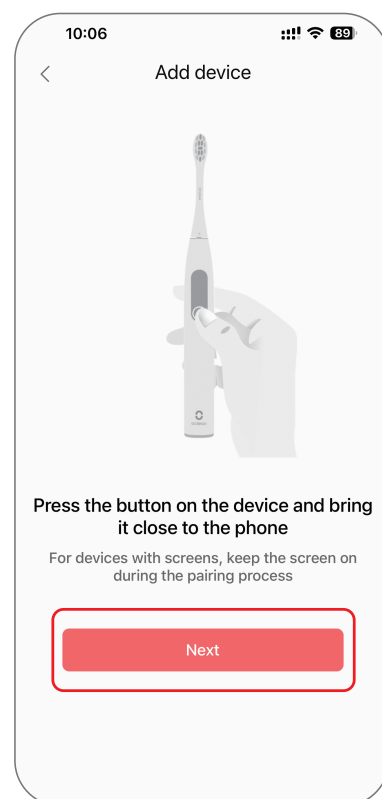

8 Tap the first toothbrush device on the page.

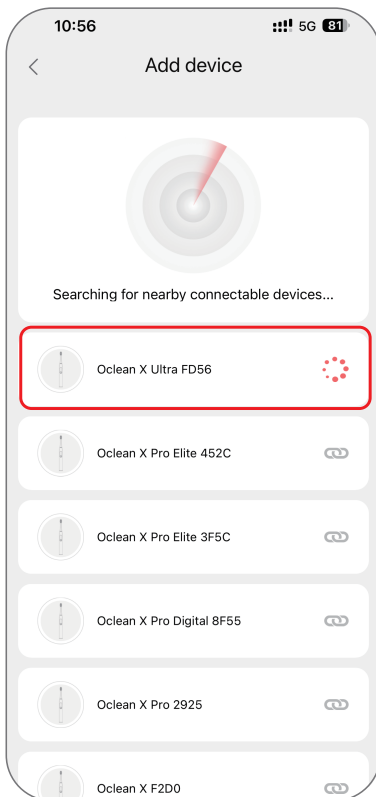

9 Input Wifi account&pass-word, and tap "Network Help"

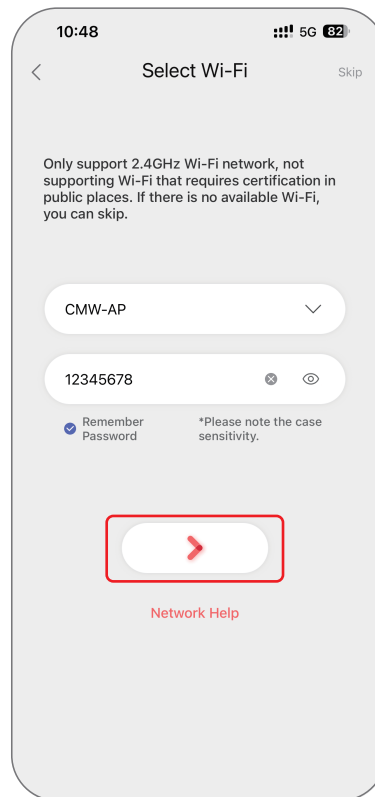

10 Tap "Set later"

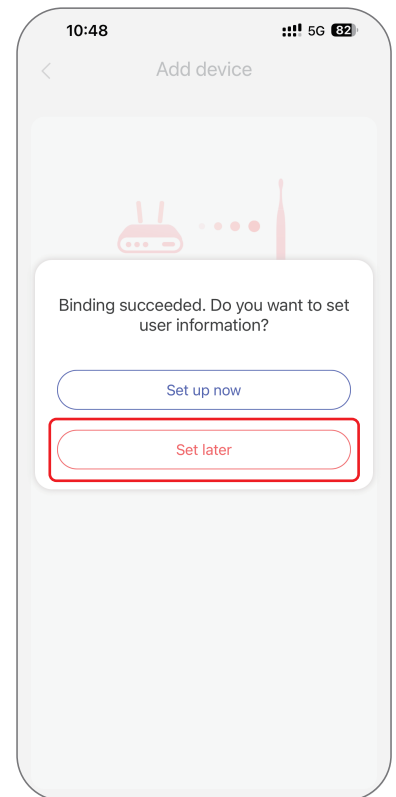

11 Tap "Set later"



12 Tap the toothbrush device to enter the setting page.

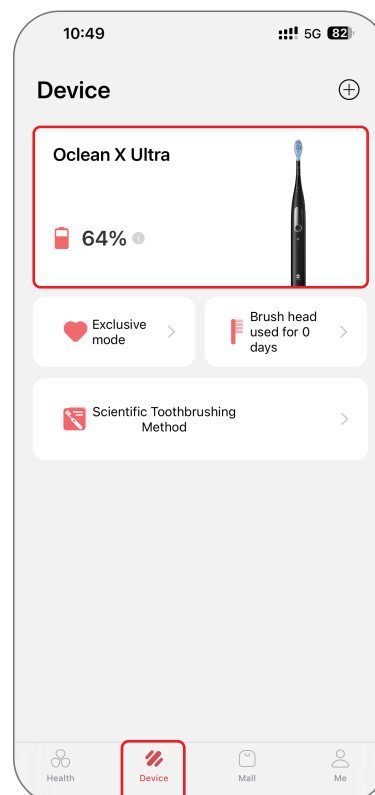

13 Configure your personal preferences on the setting page.

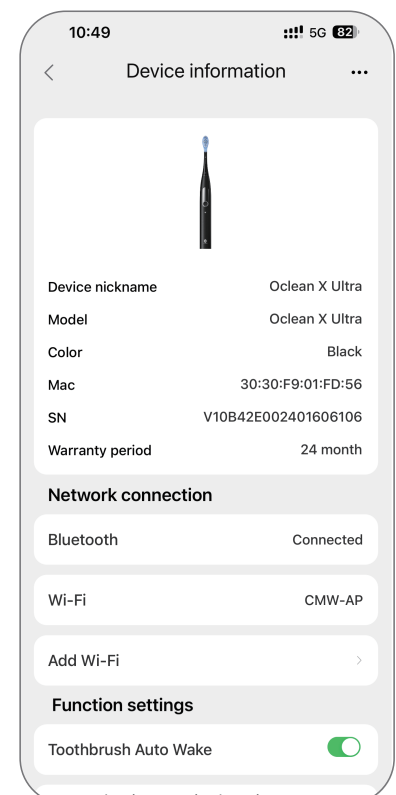

Touch the screen to set the toothbrush

Even without connecting to the App, you can swipe up and down on the touch screen to select your favorite mode settings. After completing, the settings will be automatically memorized and the device will operation according to the settings in subsequent operations.

If the mode is changed through the touch screen after the App pushes a brushing plan, the toothbrush will no longer execute the brushing plan previously pushed by the App.

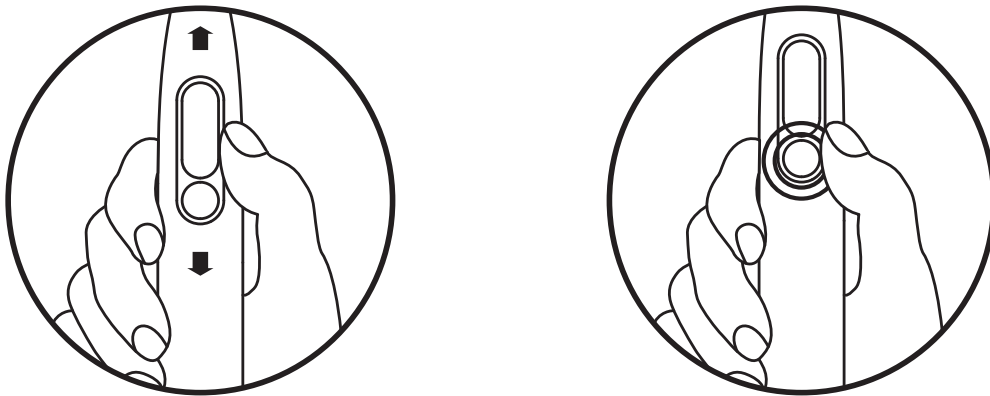

Fresh Clover

Fresh Clover achieves closed-loop management of daily oral health. Record the brushing times every day (it is required to brush teeth more than twice a day for adults), the brushing duration (more than 2 minutes each time), and the teeth brushing score (more than 90 points on average each time). Fresh Clover, oral healthy every day.

Over Pressure Reminder

If too much pressure is applied during teeth brushing, it may damage the gums or tooth surface. Therefore, when the toothbrush detects excessive pressure, it will give sound as reminder and the light at the bottom will turn on in red. (This function is enabled by default)

Timing and Brushing Area Change Reminder

The brushing duration of the default brushing plan is 2 minutes, and the vibration state changes momentarily every 30 seconds to remind the user to change the brushing area.

Brushing Report

After brushing the teeth, the screen of this product will display the brushing duration, brushing score, and brushing blind area prompt.

View the brushing records in the App

The App can only obtain the brushing data after the toothbrush is bound and connected to the App. The storage capacity of the toothbrush itself is limited and can usually only store brushing data for no more than 7 days.

Toothbrush Charging

Before charging, dry the device and place it on the wireless charging stand to charge. You can judge the charging status by the indicator light on the wireless charger and the battery level by the battery ratio displayed on the Oclean electric toothbrush screen. Do not place the toothbrush on the wireless charging stand for a long time to charge repeatedly. After it is fully charged, please remove the toothbrush from the wireless charging stand, and charge it only when the toothbrush reminds that the battery is low.

Low Battery Reminder

When the battery level of the toothbrush is less than 10%, the screen will frequently display a low battery prompt, indicating that it needs to be charged. When the battery level is below 1%, the device cannot be turned on, the motor will vibrate to prompt, and the screen will not turn on.

Important Charging Reminder

This electric toothbrush is equipped with wireless fast charging function, and it is recommended to connect it for charging only when the toothbrush needs charging. Do not place the toothbrush on the charger when it does not need to be charged and after it is fully charged. Charging at full charge for a long time will

cause the internal battery to fail prematurely and affect the user experience.

Wall-mounted Rack

The toothbrush is provided with a wall-mounted rack, providing space-saving storage.

Note

Wall-mounted rack installation method:
When installing the wall-mounted on the wall,
be sure to install it with the arrow facing upwards.

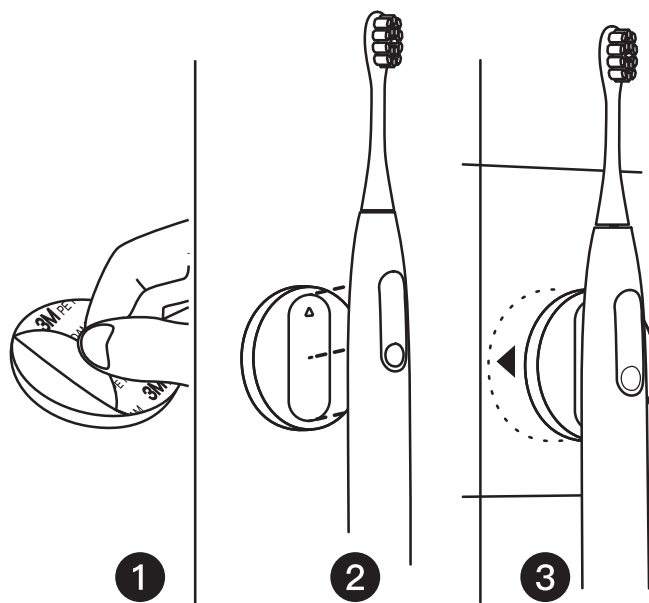

Recommended Brushing Method

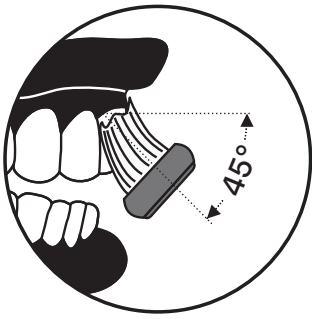

Keep the bristles at a 45° angle to the gum line and move the toothbrush slowly. During this process, it doesn't need to brush up and down manually.



Hold the toothbrush handle and move it slowly in a circular motion. Do not press it fiercely.



Rinse your mouth with clean water after brushing.

Battery Disassembly Steps

The product must be powered off before removing the battery.

After removing the battery, the battery should be disposed of safely.

Please have a professional remove the battery from the product according to the following steps.

Before disposing of the product, the battery must be removed from the product according to the following

steps:

1. First heat the charging board with hot air gun, then open the charging board along the edge of the bottom cover with tweezers.
2. Remove the bottom cover fixing screws with cross-head screwdriver and remove the bottom cover.
3. Pry the clips on both sides inward with tweezers, and push the motor shaft until it comes out of the movement.
4. Cut the charging cable at the bottom of the battery with pliers, open the buckle, and take out the battery.

Battery Safety Warnings

1. It is prohibited to disassemble, impact, squeeze or throw the battery into fire
2. If the product is severely swollen, do not continue to use it
3. Please do not place in high temperature environment
4. Do not use the battery after it is soaked in water

Product specifications

Product Name	Oclean WiFi Smart Sonic Electric Toothbrush
Model	V8100
IP Rating	IPX7
Charger	WP02 Wireless Charging Base
Input	5V \equiv 1A
Battery Life*	40 days
Battery Capacity	1200 mAh
Charging Time	About 4.5 hours
Bluetooth	BLE 5.0
Frequency Range	WiFi: 2412MHz-2472MHz BT: 2402MHz-2480MHz

* Using default mode, it is calculated at 2 minutes/time, 2 times/day working condition.

* It must use a charger with the standard output voltage of 5V \equiv 1A and the output power below 15W to charge.