

HORIPAD Turbo
for Nintendo Switch™ / PC

Instruction Manual

Thank you for purchasing this product.

Before using this product, please read the instructions carefully.

After reading the instruction manual, please keep it for reference.



Table of Contents

Product Setup	2	Layout	4
Caution	3	Turbo / Turbo Hold Mode	5-7
Contents	3	Main Features	8
Compatibility	4		

* Make sure that your Nintendo Switch™ is updated with the latest system software.

* This controller works only in TV Mode.

* This product does not support the following features:

- Gyroscope
- Accelerometer
- IR Motion Camera
- Player LED
- HD Rumble
- HOME Button Notification LED
- NFC

Product Setup

- 1** Make sure that your Nintendo Switch™ is updated with the latest system software.

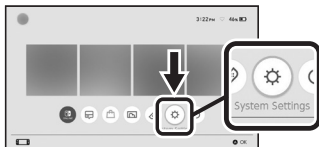

From the Home Menu select 'Settings'.

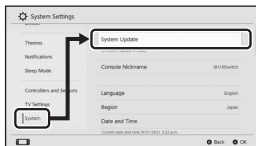

Select 'System' and then 'System Update' to update to the latest system software. (Please skip this step if system already has the latest system software.)

- 2** Connect all of the cables accordingly.

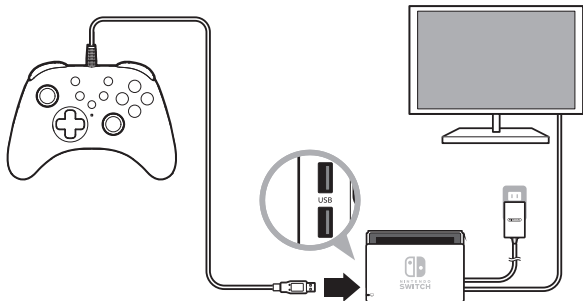



Caution

Parents/Guardians:

Please read the following information carefully.

- This product contains small parts. Keep away from children under 3 years old.
- Keep this product away from small children or infants. Seek medical attention immediately if any small parts are swallowed.
- Long cord. Strangulation hazard.
- Keep the product away from dusty or humid areas.
- Do not use this product if it has been damaged or modified.
- Do not get this product wet. This may cause an electric shock or malfunction.
- Do not place this product near heat sources or leave under direct sunlight for an extended period. Overheating may cause malfunction.
- Do not use this product with a USB hub. The product may not function properly.
- Do not touch the metal parts of the USB plug.
- Do not apply strong impact or weight on the product.
- Do not pull roughly or bend the cable of the product.
- Do not disassemble, modify or attempt to repair this product.
- If product needs cleaning, use only a soft dry cloth. Do not use any chemical agents like benzene or thinner.
- The packaging must be retained since it contains important information.
- Do not use this product for anything other than its intended purpose. We are not responsible for any accidents or damages in the event of use other than the intended purpose.

Contents



Controller × 1



Instruction Manual × 1

Compatibility

Nintendo Switch™

Nintendo Switch™ – OLED Model

Important

Please be sure to read the instruction manual for the Nintendo Switch™ before using the product with the Nintendo Switch™. Make sure that your Nintendo Switch™ is updated with the latest system software.

* An internet connection is required to update the Nintendo Switch™ to the latest system software.

Layout

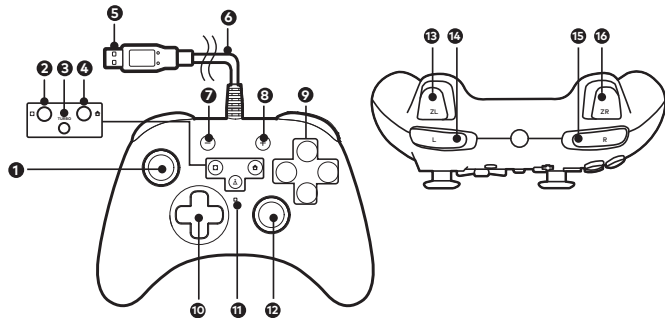

- | | | |
|--------------------|--------------------|-------------|
| ① Left Stick | ⑦ - Button | ⑬ ZL Button |
| Left stick Button | ⑧ + Button | ⑭ L Button |
| ② Capture Button | ⑨ A/B/X/Y Button | ⑮ R Button |
| ③ TURBO Button | ⑩ Directional Pad | ⑯ ZR Button |
| ④ HOME Button | ⑪ TURBO LED | |
| ⑤ USB Connector | ⑫ Right Stick | |
| ⑥ Controller cable | Right Stick Button | |

Turbo / Turbo Hold Mode

Turbo can be set to 3 different speeds.

The following buttons can be set to Turbo or Turbo Hold Mode

A Button / B Button / X Button / Y Button / L Button / R Button / ZL Button / ZR Button /
LSB Button / RSB Button / Directional Pad (UP / DOWN / LEFT / RIGHT)*

* Directional Pad (UP / DOWN / LEFT / RIGHT) is not compatible with the Turbo hold Mode, and can only be used to set Turbo Mode.

Turbo Mode

Turbo will be activated while the button is pressed.

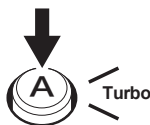

Turbo Hold Mode

Continuously activates the button function without pressing the button.

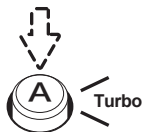

TURBO LED

 **Setting up Turbo function**
TURBO LED will turn on.



 **Turbo function activated**
TURBO LED will flash.*

* The TURBO LED will flash at a rate corresponding to the Turbo speed.

How to set up Turbo Function

① Turbo ON

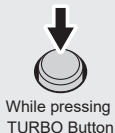

+

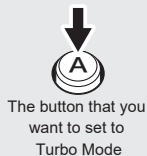

② Turbo Hold ON

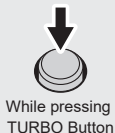

+



③ Turbo OFF



+



Turbo OFF (All buttons)

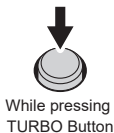

+



- * The TURBO LED flash rate corresponds to the Turbo speed and will flash as long as one of the buttons is in Turbo mode.
- * By pressing the HOME Button, all Turbo function and Turbo hold settings will be deactivated. When restarting game play, you will need to set the Turbo function again.
- * Turbo Function may not be compatible with all software titles. Please try adjusting the Turbo settings or simply turn off TURBO.

How to change Turbo Speed

Turbo Mode can be set to 3 different speeds.

5 times/second $\begin{matrix} \rightarrow \\ \leftarrow \end{matrix}$ **10** times/second $\begin{matrix} \rightarrow \\ \leftarrow \end{matrix}$ **20** times/second



While pressing
TURBO Button



Right Stick

**Increase the speed
by one level**



While pressing
TURBO Button



Right Stick

**Decrease the speed
by one level**

- * When setting Turbo speed, TURBO LED will flash at a rate corresponding to the set Turbo speed.
- * Turbo speed is set to 10 times/second by default.
- * Analog Sticks must be returned to the neutral position before changing to the next turbo speed.

Main Features

External Dimensions : W 6.1 × D 24.6 × H 4.3 in / W 15.5 × D 6.25 × H 11 cm

Weight : 0.54 lbs / 246 g

Connection Type : USB Type-A

Cable Length : 10 ft / 3 m

THE FCC WANTS YOU TO KNOW

This device complies with part 15 of the FCC Rules. Operation is subject to the following two conditions: (1) This device may not cause harmful interference, and (2) this device must accept any interference received, including interference that may cause undesired operation.

NOTE: This equipment has been tested and found to comply with the limits for a Class B digital device, pursuant to part 15 of the FCC Rules. These limits are designed to provide reasonable protection against harmful interference in a residential installation. This equipment generates, uses and can radiate radio frequency energy and, if not installed and used in accordance with the instructions, may cause harmful interference to radio communications. However, there is no guarantee that interference will not occur in a particular installation.

If this equipment does cause harmful interference to radio or television reception, which can be determined by turning the equipment off and on, the user is encouraged to try to correct the interference by one or more of the following measures:

- Reorient or relocate the receiving antenna.
- Increase the separation between the equipment and receiver.
- Connect the equipment into an outlet on a circuit different from that to which the receiver is connected.
- Consult the dealer or an experienced radio/TV technician for help.

CAN ICES-003(B) / NMB-003(B)

This Class B digital apparatus complies with Canadian ICES-003.

Cet appareil numérique de la classe B est conforme à la norme NMB-003 du Canada.

Simplified Declaration of Conformity

Hereby, HORI declares that this product is in compliance with Directive 2014/53/EU.

The full text of the EU declaration of conformity is available at the following internet address:

<https://hori.co.uk/consumer-information/>

For UK: Hereby, HORI declares that this product is in compliance with the relevant statutory requirements.

The full text of the declaration of conformity is available at the following internet address:

<https://hori.co.uk/consumer-information/>

PRODUCT DISPOSAL INFORMATION

Where you see this symbol on any of our electrical products or packaging, it indicates that the relevant electrical product or battery should not be disposed of as general household waste in Europe. To ensure the correct waste treatment of the product and battery, please dispose of them in accordance with any applicable local laws or requirements for disposal of electrical equipment or batteries. In so doing, you will help to conserve natural resources and improve standards of environmental protection in treatment and disposal of electrical waste.



US

Warranty

HORI warrants to the original purchaser that the product purchased new in its original packaging shall be free of any defects in material and workmanship for a period of 90 days from the original date of purchase.

If the warranty claim cannot be processed through the original retailer, please address directly to HORI at info@horiusa.com.

Please visit <http://stores.horiusa.com/policies/> for warranty details.

EU

Warranty

For all warranty claims made within the first 30 days after purchase, please check with the retailer where the original purchase was made for details.

If the warranty claim cannot be processed through the original retailer or for any other inquiries pertaining to our products, please address directly to HORI at info@horiuk.com.

- Actual product may differ from image.
- The manufacturer reserves the right to change the product design or specifications without notice.
- Nintendo Switch is a trademark of Nintendo. © 2023 Nintendo. Licensed by Nintendo.
- HORI & HORI logo are registered trademarks of HORI.
- All other trademarks are the property of their respective owners.